

Weight: 562 g

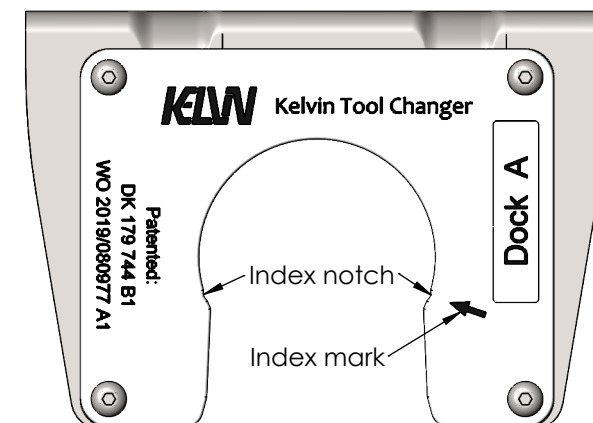

ITEM NO.	PART NUMBER	DESCRIPTION	QTY.
1	032-03-DockHolder		1
3	031-03-DockPlate		1
4	045-01-DockLabel	Mounted by end user	1
8	SvingDamperDock		4
9	M5-6-but		8

Rev:	Revision text:	Change order nr:	Date:	Sign:
Material:		Tolerance:	Colour:	
Status:		Surface treatment:		
4TECH 4TECH Aps Bülowsgade 36 8000 Aarhus C www.4tech.dk		Sheet:	Scale:	Date:
		A4	1:2	12/10 19
Description:		Item number:	Sign:	
		006-03-DockingStation	HF	
		BOM		
				1/3

Variant with mounting plate facing upwards behind the docking plate

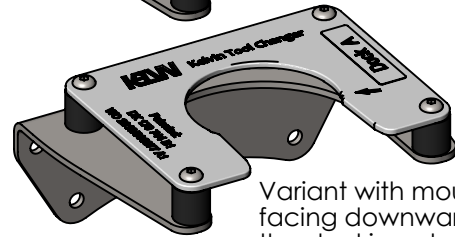
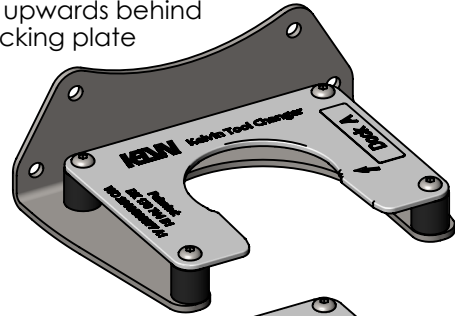

Variant with mounting plate facing downwards behind the docking plate

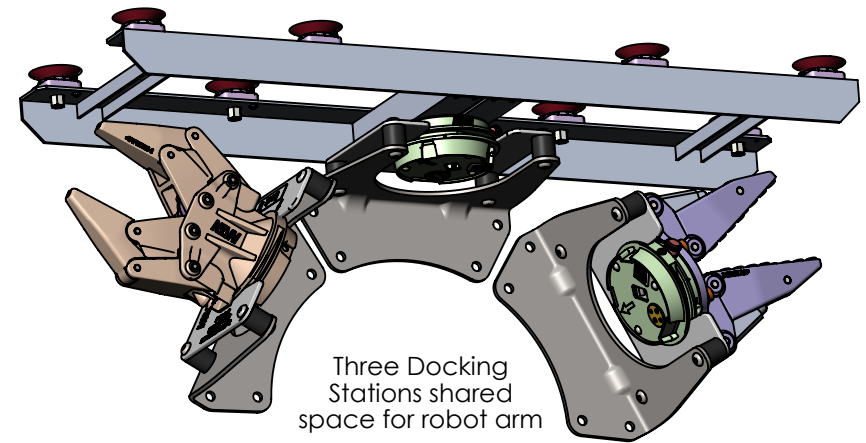

Three Docking Stations shared space for robot arm

Tool on the upper side of the docking station

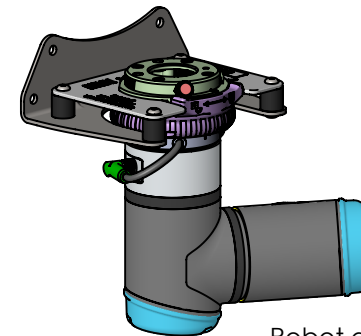

Robot arm with tool changer

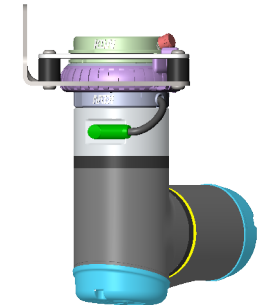

Robot arm downside the docking station

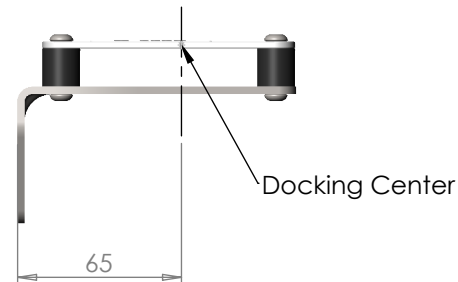
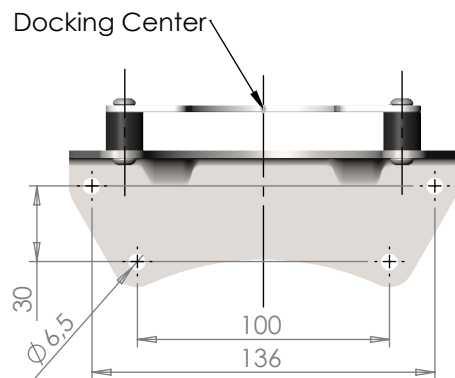
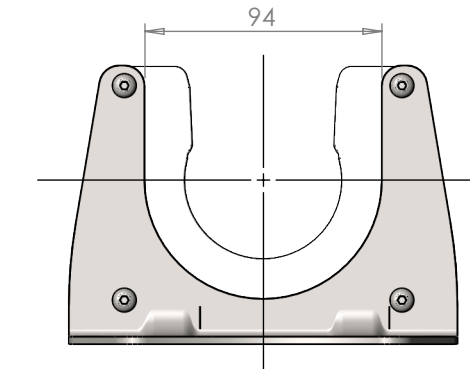

Docking Center

Notch for positioning tools during parking

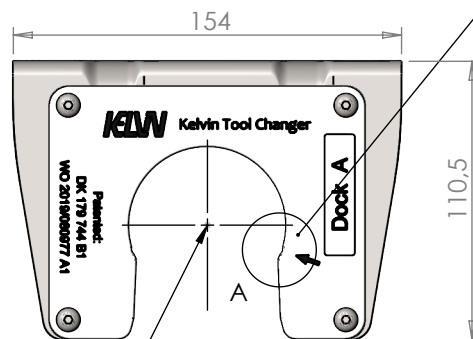

Docking Center

Index marking (parking position)

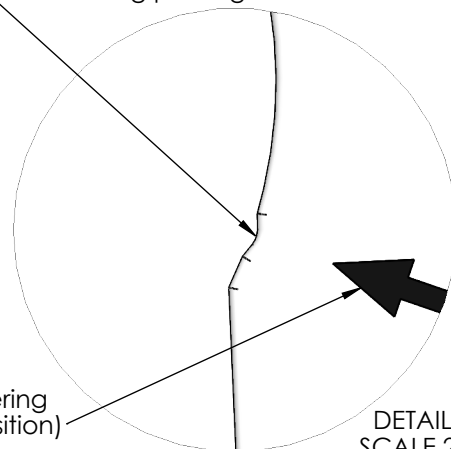

DETAIL A
SCALE 2 : 1

Rev:	Revision text:	Change order nr:	Date:	Sign:
Material:		Tolerance:	Colour:	
Status:		Surface treatment:		
4TECH 4TECH Aps Bülowsgade 36 8000 Aarhus C www.4tech.dk		Sheet:	Scale:	Date:
		A4	1:3	12/10 19
Description:		Item number:	Sign:	HF
		006-03-DockingStation		

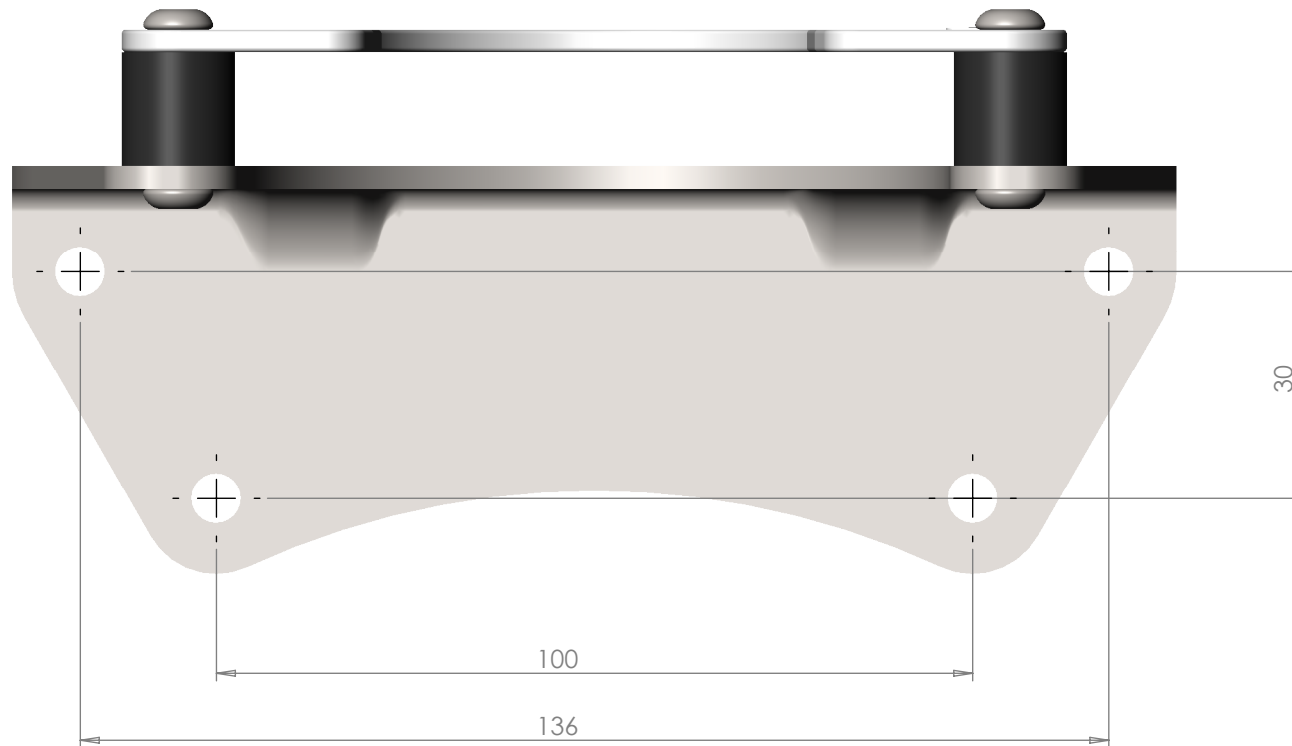

Rev:	Revision text:	Change order nr:	Date:
Material:		Tolerance:	Colour:
Status:		Surface treatment:	
4TECH 4TECH Aps Bülowsgade 36 8000 Aarhus C www.4tech.dk		Sheet:	Scale:
Description:		Item number:	
1:1 drawing for mounting holes		006-03-DockingStation	1/3